

UNIVERSAL TOWER LIFTING SYSTEM

Flexible lifting of all towers regardless of size and type

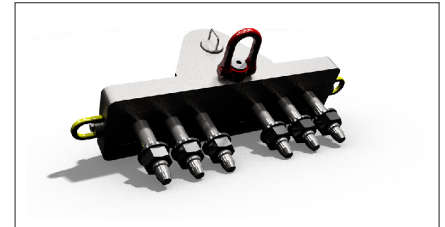
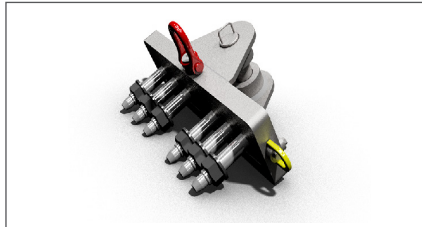
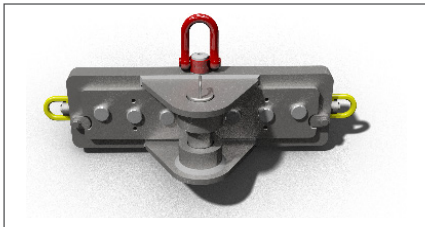

The universal tower lifting system consists of a flexible yet standard bracket used in combination with an adapter piece and a standard spreader bar.

When switching between tower diameters and flange types, the standard tower lifting bracket can be re-used, and the only required adjustment of the bracket is the drilling and

threading of the adapter piece. The lift is performed using a standard spreader bar.

The solution gives you the chance to lower equipment investment costs significantly, to reduce inventory levels and - in short - to simplify the entire tower installation process.

GENERAL FACTS & SAFETY

- Mounted with pin bolts
- Safe and easy handling thanks to pad eyes
- Bracket can be designed with 4, 6, or 8 holes depending on strategy
- Bracket designed with safety factor 2 according to EN 13155
- Pads designed with safety factor 3 according to EN 13155
- Adapter cannot be mounted in the wrong way
- Adapter is bolted onto the bracket, i.e. no loose parts when released
- Lift is performed directly over the flange
- By using the spreader bar, the brackets will not move when dismantled from the flange, i.e. no risk of personal injury for technicians
- Brackets protect the towers from ovalization during transport and storage

YOUR DIRECT ADVANTAGES

- Substantial reduction of investment costs for tower lifting equipment
- Short delivery time due to standard modules
- Significant cutback on inventory levels as 80% of the solution can be re-used
- Adapter pieces can be purchased in large quantities at low cost and put on stock, ready for use
- Simplification of the tower installation process

